

Specifications

备注 (Remark)

1. 材料 (MATERIAL)

胶芯: PA6T+30%G.F UL94V-0, 颜色: 黑色.

Housing: PA6T+30%G.F UL94V-0, Color: Black

端子: 磷/青铜, 镍底30u"MIN, 表面镀金1u"MIN

Contact: Phosphor bronze, 1u"MIN GOLD PLATING OVER ALL
30u" MIN NICKEL UNDERPLATING OVER ALL

2. 特性 (characteristics):

额定电流: 2 AMP

Rating Current: 2 AMP.

接触阻抗: 20 mΩ MAX.

Contact Resistance: 20 mΩ MAX.

绝缘阻抗: 1000 MΩ MIN.

Insulating Resistance: 1000 MΩ MIN.

耐电压: AC 500V/分钟.

Withstanding Voltage: AC 500V/Minute.

温度范围: -40° C to +105° C

Temperature Range: -40° C to +105° C

Ordering Information

F243-11 XX XX X RU X 1

NO. OF PINS
PER ROW
1-40P

Contact
Full Cr Gold
A0=0.8u"
A1=1u"
A2=1.5u"
A3=2u"
A4=3u"
A5=5u"
A6=10u"
A7=15u"
A8=20u"
A9=30u"

Plating
Semi-gold
B0=0.8u"
B1=1u"
B2=1.5u"
B3=2u"
B4=3u"
B5=5u"
B6=10u"
B7=15u"
B8=20u"
B9=30u"

INSULATOR
MATERIAL:
B: PA6T
C: PA9T
D: LCP

PACKING
A: PE Bag
B: Tape & Reel
C: Tube
D: Tube+CAP
E: Tray

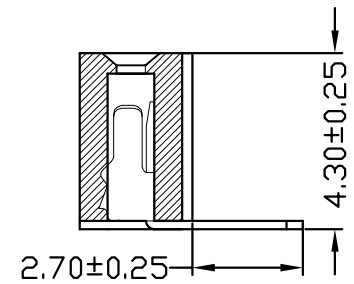
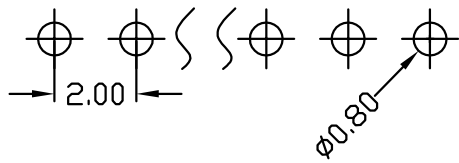
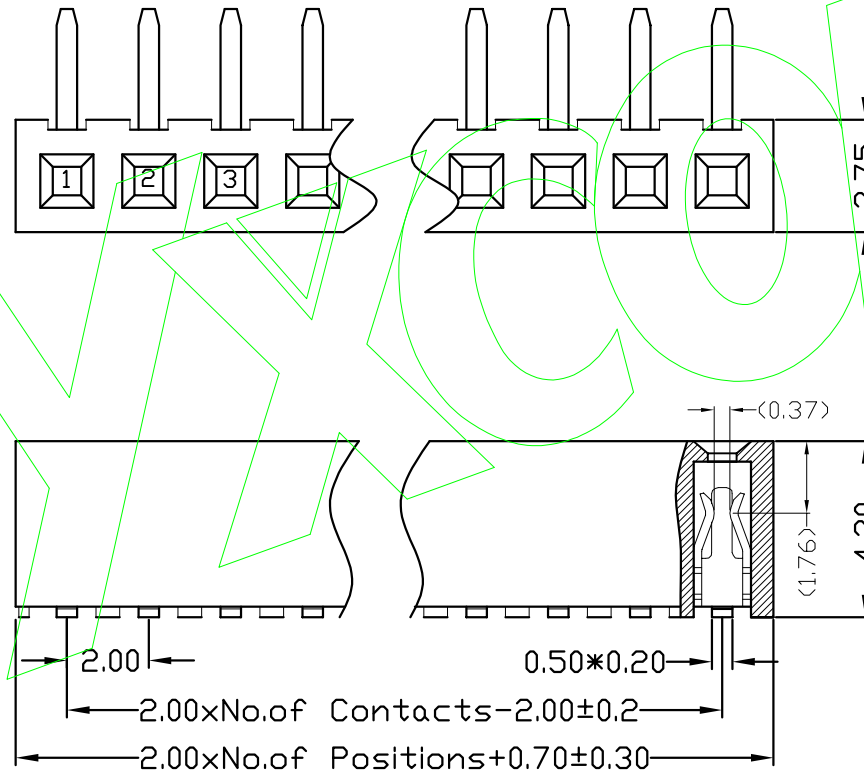

			OPERATION		SCALE		Fit		东莞市宇熙精密连接器有限公司 www.yxcon.com Dongguan Yuxi Electronic Co., Ltd.	
			X.X	±0.25	UNIT		MM			
			X.XX	±0.20	SIZE	A4	DESIGN	刘伟 2020.12.03	PART NO.	F243-11XXXXXRUX1
			X.XXX	±0.10	SHEET	1/1	CHECK		TITLE:	2.0间距 塑高4.3 单排母 90度 U型 波浪型 塑宽2.75
REV	DATE	SYMBOL	MODIFICATION DESCRIPTION		DIAM	TOL	PROJ.	APPROVE	Customer No.	

Specifications

备注 (Remark)

1. 材料 (MATERIAL)

胶芯: PA9T+30%G.F UL94V-0, 颜色: 黑色.

Housing: PA9T+30%G.F UL94V-0, Color: Black

端子: 磷/青铜, 镍底30u"MIN, 表面镀金1u"MIN

Contact: Phosphor bronze, 1u"MIN GOLD PLATING OVER ALL
30u" MIN NICKEL UNDERPLATING OVER ALL

2. 特性 (characteristics):

额定电流: 2 AMP

Rating Current: 2 AMP.

接触阻抗: 20 mΩ MAX.

Contact Resistance: 20 mΩ MAX.

绝缘阻抗: 1000 MΩ MIN.

Insulating Resistance: 1000 MΩ MIN.

耐电压: AC 500V/分钟.

Withstanding Voltage: AC 500V/Minute.

温度范围: -40° C to +105° C

Temperature Range: -40° C to +105° C

Ordering Information

F243-11 XX XX X RU X 2

NO. OF PINS
PER ROW
1~40P

Contact

Full of Gold

A0=0.8u"

A1=1u"

A2=1.5u"

A3=2u"

A4=3u"

A5=5u"

A6=10u"

A7=15u"

A8=20u"

A9=30u"

S1=Ordinary Tin Plated

S2=Matte Tin Plated

S3=Tin-plated High-temperature

Plating

Semi-gold

B0=0.8U'

B1=1U'

B2=1.5U'

B3=2U'

B4=3U'

B5=5U'

B6=10U'

B7=15U'

B8=20U'

B9=30U'

INSULATOR

MATERIAL:

B: PA6T

C: PA9T

D: LCP

PACKING

A: PE Bag

B: Tape & Reel

C: Tube

D: Tube+CAP

E: Tray

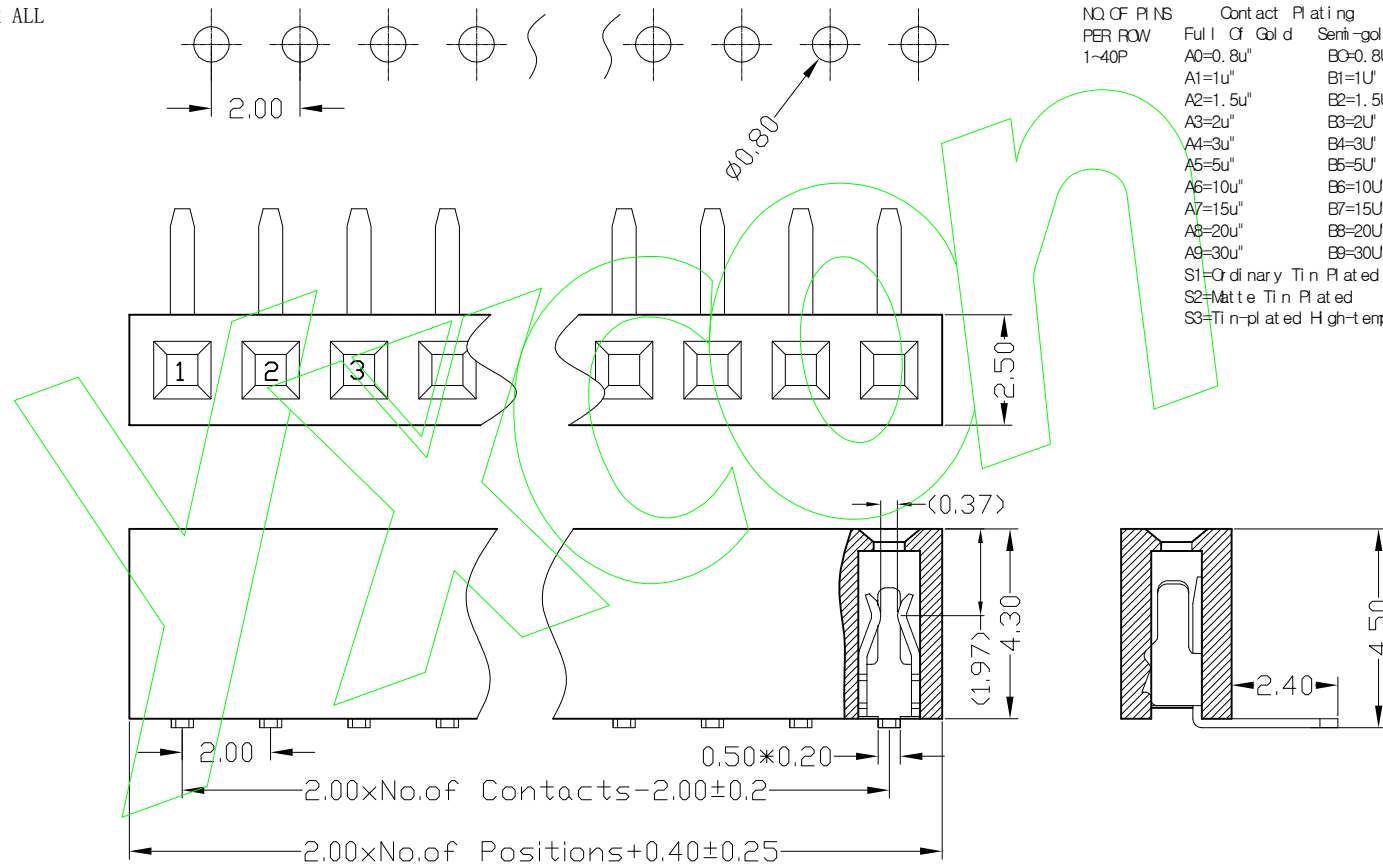

			OPERATION		SCALE		Fit		东莞市宇熙精密连接器有限公司 www.yxcon.com Dongguan Yuxi Electronic Co., Ltd.	
			X.X	± 0.25	UNIT		MM			
			X.XX	± 0.20	SIZE	A4	DESIGN	刘伟 2020.12.03	PART NO.	F243-11XXXXXRUX2
			X.XXX	± 0.10	SHEET	1/1	CHECK		TITLE:	2.0间距 塑高4.3 单排母 90度 U型 凹槽型
REV	DATE	SYMBOL	MODIFICATION DESCRIPTION		ANGLE	$\pm 3^\circ$	PROJ.		APPROVE	Customer No.
					DIM	TOL				

Specifications

备注 (Remark)

1. 材料 (MATERIAL)

胶芯: PA6T+30%G.F UL94V-0, 颜色: 黑色.

Housing: PA6T+30%G.F UL94V-0, Color: Black

端子: 磷/青铜, 镍底30u"MIN, 表面镀金1u"MIN

Contact: Phosphor bronze, 1u"MIN GOLD PLATING OVER ALL
30u" MIN NICKEL UNDERPLATING OVER ALL

2. 特性 (characteristics):

额定电流: 2 AMP

Rating Current: 2 AMP.

接触阻抗: 20 mΩ MAX.

Contact Resistance: 20 mΩ MAX.

绝缘阻抗: 1000 MΩ MIN.

Insulating Resistance: 1000 MΩ MIN.

耐电压: AC 500V/分钟.

Withstanding Voltage: AC 500V/Minute.

温度范围: -40° C to +105° C

Temperature Range: -40° C to +105° C

Ordering Information

F243-11 XX XX X RU X 3

NO. OF PINS PER ROW	Contact Plating	INSULATOR MATERIAL:	PACKING
1-40P	Full Cr Gold	B: PA6T	A: PE Bag
	Semi-gold	C: PA9T	B: Tape & Reel
		D: LCP	C: Tube
			D: Tube+CAP
			E: Tray

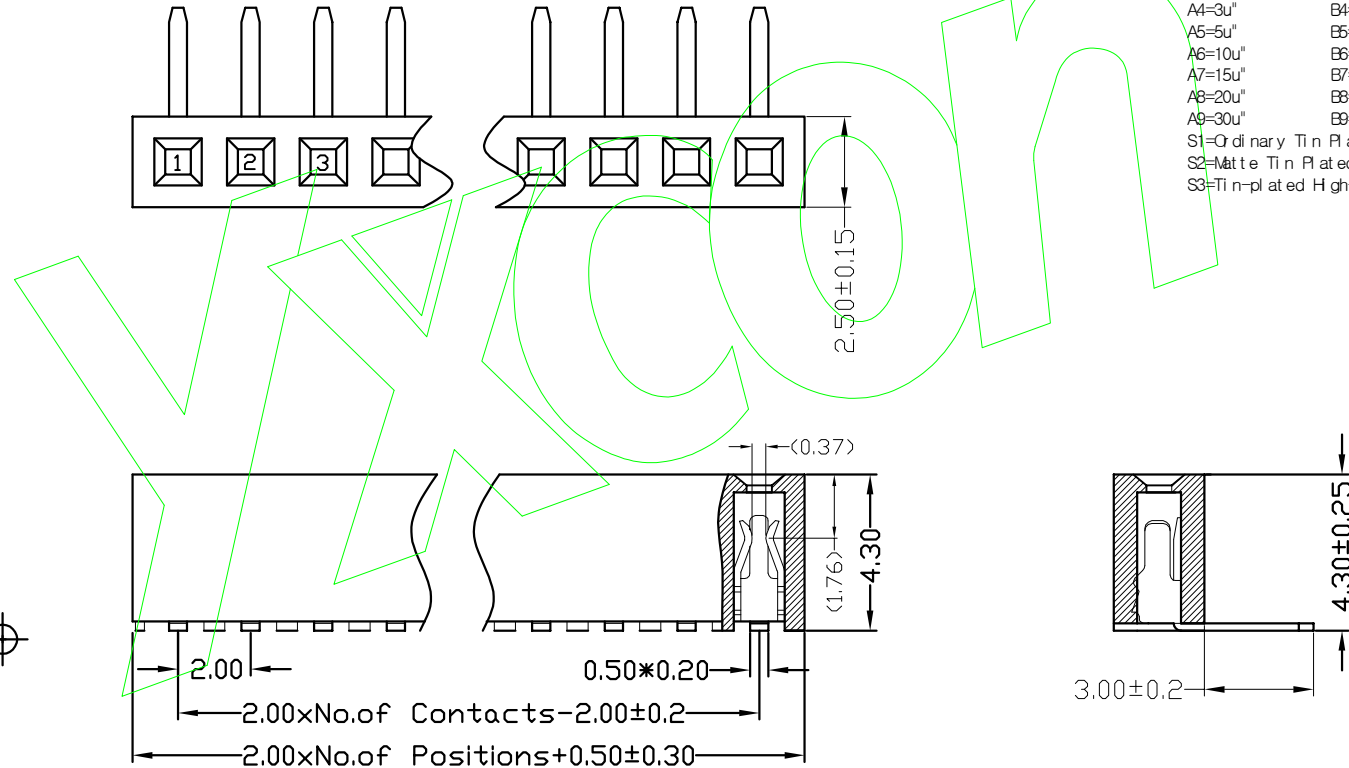

REV	DATE	SYMBOL	MODIFICATION DESCRIPTION	OPERATION	SCALE	Fit	Yxcon 东莞市宇熙精密连接器有限公司			
				X.X ±0.25	UNIT	MM	www.yxcon.com Dongguan Yuxi Electronic Co., Ltd.			
				X.XX ±0.20	SIZE	A4	DESIGN	刘伟 2020.12.03	PART NO	F243-11XXXXXRU3
				X.XXX ±0.10	SHEET	1/1	CHECK		TITLE	2.0间距 塑高4.3 双排母 90度 U型 带杠
				Angle ±3°	PROJ.	☉	APPROVE		Customer No.	
				DIM TOL						