

Specifications

备注 (Remark)
 1. 材料 (MATERIAL)
 胶芯: PA6T+30%G.F UL94V-0, 颜色: 黑色.
 Housing: PA6T+30%G.F UL94V-0, Color: Black
 四方针: 黄铜, 镍底30u"MIN, 表面镀金0.8u"MIN
 Contact: Brass, 0.8u"MIN GOLD PLATING OVER ALL
 30u" MIN NICKEL UNDERPLATING OVER ALL

2. 特性 (characteristics):
 额定电流: 1 AMP
 Rating Current: 1 AMP.
 接触阻抗: 20 mΩ MAX.
 Contact Resistance: 20 mΩ MAX.
 绝缘阻抗: 1000 MΩ MIN.
 Insulating Resistance: 1000 MΩ MIN.
 耐电压: AC 500V/分钟.
 Withstanding Voltage: AC 500V/Minute.
 温度范围: -40° C to +105° C
 Temperature Range: -40° C to +105° C

Ordering Information

P3XX-11 XX XX X R XXX X 1

HEIGHT OF HOUSING	NO. OF PINS PER ROW	Contact Full of Gold	Plating Semi-gold	INSULATOR LENGTH MATERIAL	PACKING
16: 1.6mm	1~50P	A0=0.8u"	B0=0.8u"	B: PA6T	A: PE Bag
20: 2.0mm		A1=1u"	B1=1u"	C: PA6T	B: Tape & Reel
25: 2.54mm		A2=1.5u"	B2=1.5u"	D: LCP	C: Tube
		A3=2u"	B3=2u"		D: Tube+CAP
		A4=3u"	B4=3u"		E: Tray
		A5=5u"	B5=5u"		
		A6=10u"	B6=10u"		
		A7=15u"	B7=15u"		
		A8=20u"	B8=20u"		
		A9=30u"	B9=30u"		
		S1=0 dinary Tin Plated			
		S2=Matte Tin Plated			
		S3=Tin-plated High-temperature			

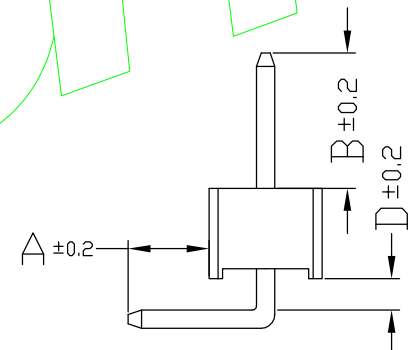
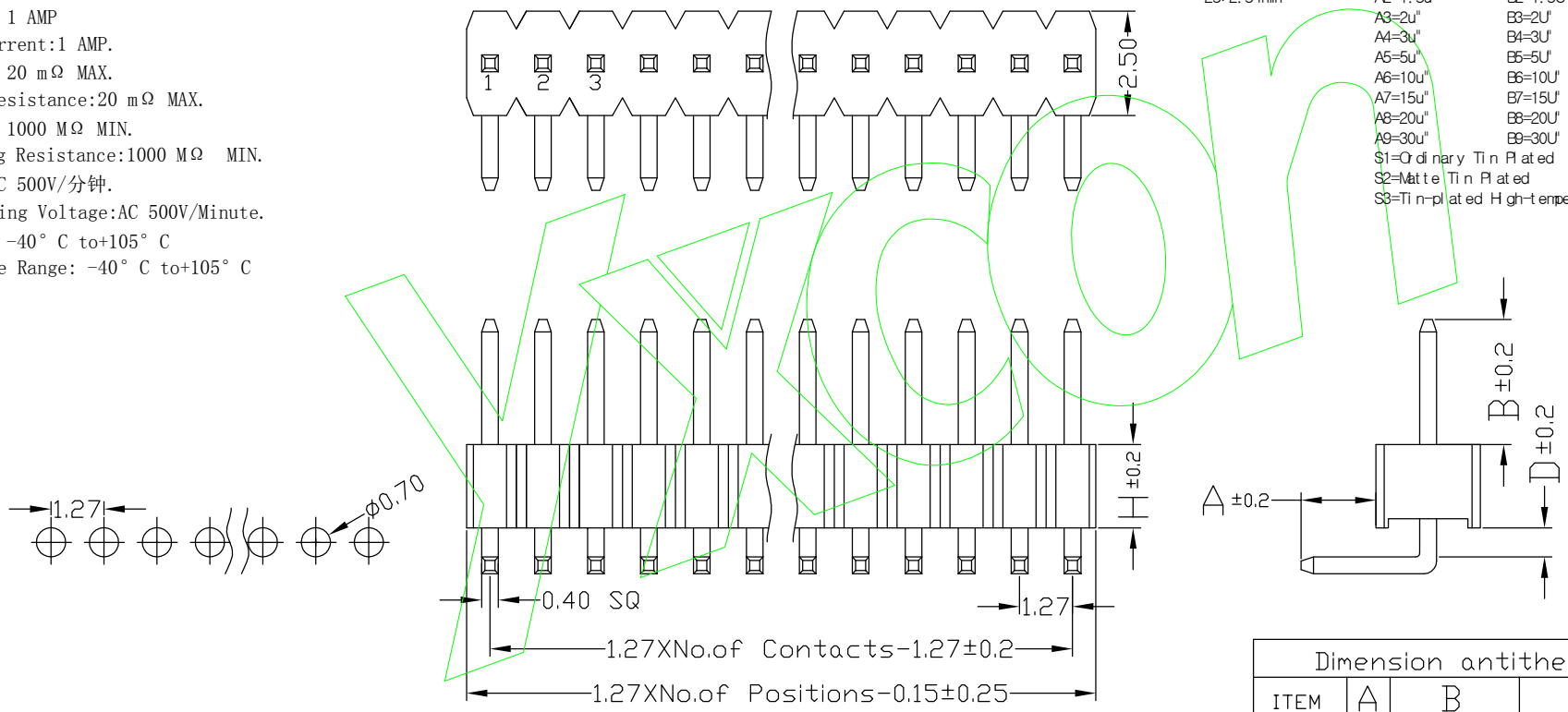

ITEM	A		B		H			D		
Standard	1.8	1.8	3.0	4.0	1.6	2.0	2.5	0	1.0	1.2
Alternate										

REV	DATE	SYMBOL	MODIFICATION DESCRIPTION	OPERATION	SCALE	Fit	东莞市宇熙精密连接器有限公司 Dongguan Yuxi Electronic Co., Ltd.							
				X.X ±0.25	UNIT	MM								
				X.XX ±0.20	SIZE	A4					DESIGN	周芳杰 2021.6.15	PART NO	P3XX-11XXXXXXXXXX1
				X.XXX ±0.10	SHEET	1/1					CHECK		TITLE	1.27间距 单排排针 单塑 90度
				Angle ±3°	PROJ.	☉					APPROVE		Customer No.	
				DIM TOL										

Specifications

备注 (Remark)
 1. 材料 (MATERIAL)
 胶芯: PA6T+30%G.F UL94V-0, 颜色: 黑色.
 Housing: PA6T+30%G.F UL94V-0, Color: Black
 四方针: 黄铜, 镍底30u~MIN, 表面镀普金
 Contact: Brass, GOLD PLATING OVER ALL
 30u~ MIN NICKEL UNDERPLATING OVER ALL

2. 特性 (characteristics):
 额定电流: 1 AMP
 Rating Current: 1 AMP.
 接触阻抗: 20 mΩ MAX.
 Contact Resistance: 20 mΩ MAX.
 绝缘阻抗: 1000 MΩ MIN.
 Insulating Resistance: 1000 MΩ MIN.
 耐电压: AC 500V/分钟.
 Withstanding Voltage: AC 500V/Minute.
 温度范围: -40° C to +105° C
 Temperature Range: -40° C to +105° C

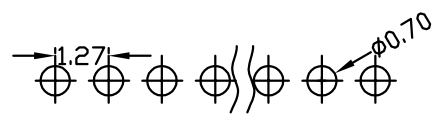
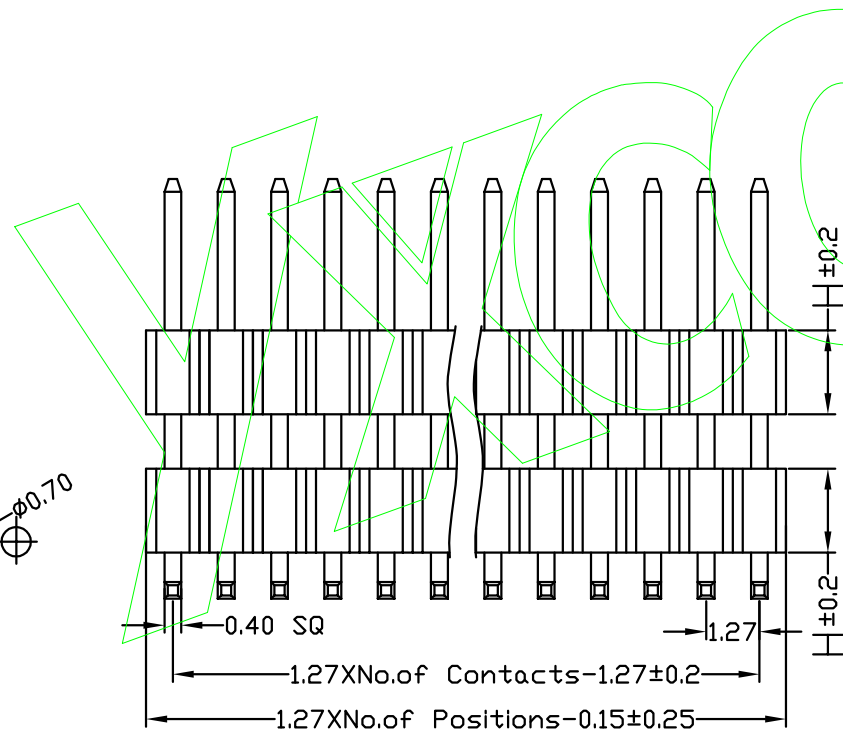
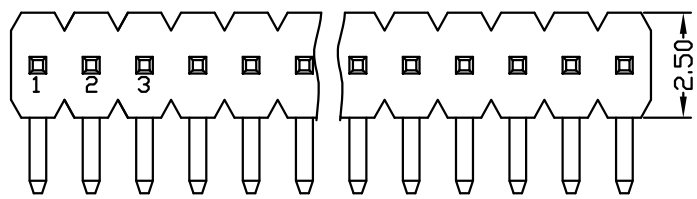

Ordering Information

P3XX-21 XX XX X R XXX X 1

HEIGHT OF HOUSING	NO. OF PINS PER ROW	Contact Full of Gold	Contact Plating	INSULATOR MATERIAL	INSULATOR LENGTH	PACKING
16: 1.6mm	1-50P	A0=0.8u"	BO=0.8U"	B: PA6T	TERMINAL	A: PE Bag
20: 2.0mm		A1=1u"	B1=1U"	C: PA9T		C: Tube
25: 2.54mm		A2=1.5u"	B2=1.5U"	D: LCP		D: Tube+CAP
		A3=2u"	B3=2U"			E: Tray
		A4=3u"	B4=3U"			
		A5=5u"	B5=5U"			
		A6=10u"	B6=10U"			
		A7=15u"	B7=15U"			
		A8=20u"	B8=20U"			
		A9=30u"	B9=30U"			
		S1=Ordinary Tin Plated				
		S2=Matte Tin Plated				
		S3=Tin-plated High-temperature				

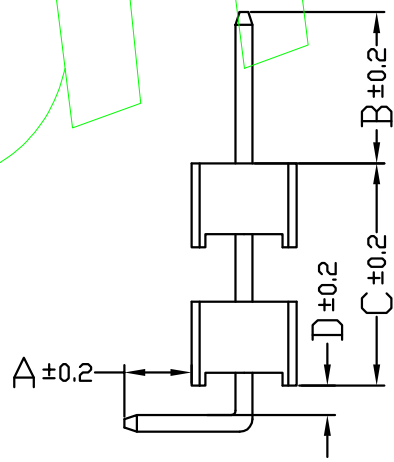

ITEM	A	B	H	D	C
Standard	1.8	1.8 3.0 4.0	1.6 2.0 2.5 0	1.0 1.2	
Alternate					

REV	DATE	SYMBOL	MODIFICATION DESCRIPTION	OPERATION		SCALE		Fit	DESIGN	周芳杰 2021.6.15	PART NO	P3XX-21XXXXRXXXX1
				X.X	±0.25	UNIT	MM					
				X.XX	±0.20	SIZE	A4	CHECK			TITLE	1.27间距 单排排针 双塑 90度
				X.XXX	±0.10	SHEET	1/1	APPROVE			Customer No.	
				Angle	±3°	PROJ.	☉					
				DIM	TOL							

Yxcon 东莞市宇熙精密连接器有限公司
 Dongguan Yuxi Electronic Co., Ltd.

Specifications

备注 (Remark)

1. 材料 (MATERIAL)

胶芯: PA9T+30%G.F UL94V-0, 颜色: 黑色.

Housing: PA9T+30%G.F UL94V-0, Color: Black

四方针: 黄铜, 镍底30u"MIN, 表面镀金0.8u"MIN

Contact: Brass, 0.8u"MIN GOLD PLATING OVER ALL
30u" MIN NICKEL UNDERPLATING OVER ALL

2. 特性 (characteristics):

额定电流: 1 AMP

Rating Current: 1 AMP.

接触阻抗: 20 mΩ MAX.

Contact Resistance: 20 mΩ MAX.

绝缘阻抗: 1000 MΩ MIN.

Insulating Resistance: 1000 MΩ MIN.

耐电压: AC 500V/分钟.

Withstanding Voltage: AC 500V/Minute.

温度范围: -40° C to +105° C

Temperture Range: -40° C to +105° C

Ordering Information

P310-11 XX XX X R XXX X 1

HEIGHT OF HOUSING	NO. OF PINS PER ROW	CONTACT PLATING FULL OF GOLD	CONTACT PLATING SEMI-GOLD	INSULATOR LENGTH MATERIAL: CF	PACKING
10: 1.0mm	1-50P	A0=0.8u" A1=1u" A2=1.5u" A3=2u" A4=3u" A5=5u" A6=10u" A7=15u" A8=20u" A9=30u"	B0=0.8U" B1=1U" B2=1.5U" B3=2U" B4=3U" B5=5U" B6=10U" B7=15U" B8=20U" B9=30U"	B: PA6T C: PA9T D: LCP	A: PE Bag C: Tube D: Tube+CAP E: Tray
		S1=Ordinary Tin Plated S2=Matte Tin Plated S3=Tin-plated High-temperature			

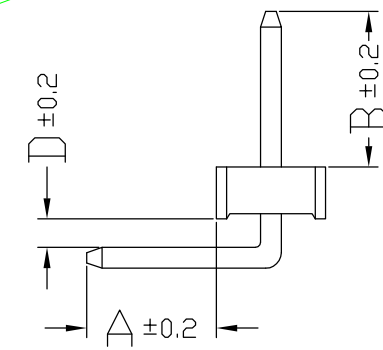
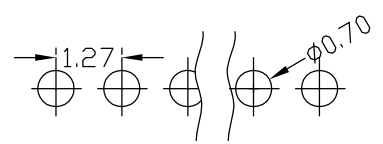
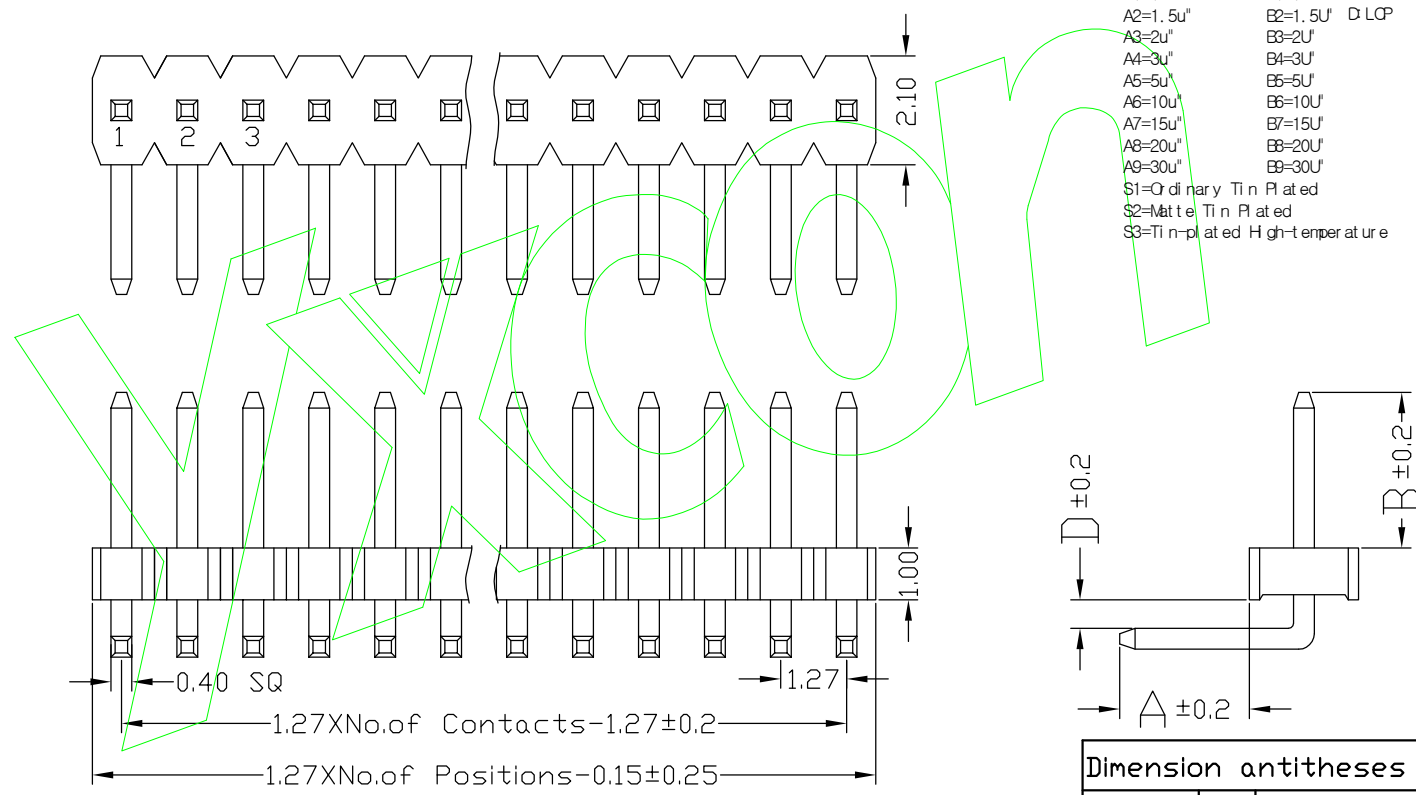

ITEM	A	B	D
Standard	1.8	1.8 3.0 4.0	0
Alternate			

				OPERATION		SCALE		Fit		东莞市宇熙精密连接器有限公司 Dongguan Yuxi Electronic Co., Ltd.	
				X.X	±0.25	UNIT		MM			
				X.XX	±0.20	SIZE	A4	DESIGN	周芳杰 2021.6.15	PART NO.	P310-11XXXXXXRX1
				X.XXX	±0.10	SHEET	1/1	CHECK		TITLE:	1.27间距 塑高1.0 单排排针 单塑 90度
REV	DATE	SYMBOL	MODIFICATION DESCRIPTION		Angle	±3°	PROJ.	APPROVE		Customer No.	
					DIM	TOL					

Specifications

备注 (Remark)
 1. 材料 (MATERIAL)
 胶芯: PA6T+30%G.F UL94V-0, 颜色: 黑色.
 Housing: PA6T+30%G.F UL94V-0, Color: Black
 四方针: 黄铜, 镍底30u"MIN, 表面镀金0.8u"MIN
 Contact: Brass, 0.8u"MIN GOLD PLATING OVER ALL
 30u" MIN NICKEL UNDERPLATING OVER ALL

2. 特性 (characteristics):
 额定电流: 1 AMP
 Raring Current: 1 AMP.
 接触阻抗: 20 mΩ MAX.
 Contact Resistance: 20 mΩ MAX.
 绝缘阻抗: 1000 MΩ MIN.
 Insulating Resistance: 1000 MΩ MIN.
 耐电压: AC 500V/分钟.
 Withstanding Voltage: AC 500V/Minute.
 温度范围: -40° C to+105° C
 Temperture Range: -40° C to+105° C

Ordering Information

P310-21 XX XX X R XXX X 1

HEIGHT OF HOUSING	NO. OF PINS PER ROW	Contact Plating Full of Gold	INSULATOR MATERIAL	LENGTH OF TERMINAL	PACKING
10: 1.0mm	1-50P	A0=0.8u" A1=1u" A2=1.5u" A3=2u" A4=3u" A5=5u" A6=10u" A7=15u" A8=20u" A9=30u"	B0=0.8U' B1=1U' B2=1.5U' B3=2U' B4=3U' B5=5U' B6=10U' B7=15U' B8=20U' B9=30U'	C PA6T D LCP	A: PE Bag B: Tape & Reel C: Tube D: Tube+CAP E: Tray

S1=Ordinary Tin Plated
 S2=Matte Tin Plated
 S3=Tin-plated High-temperature

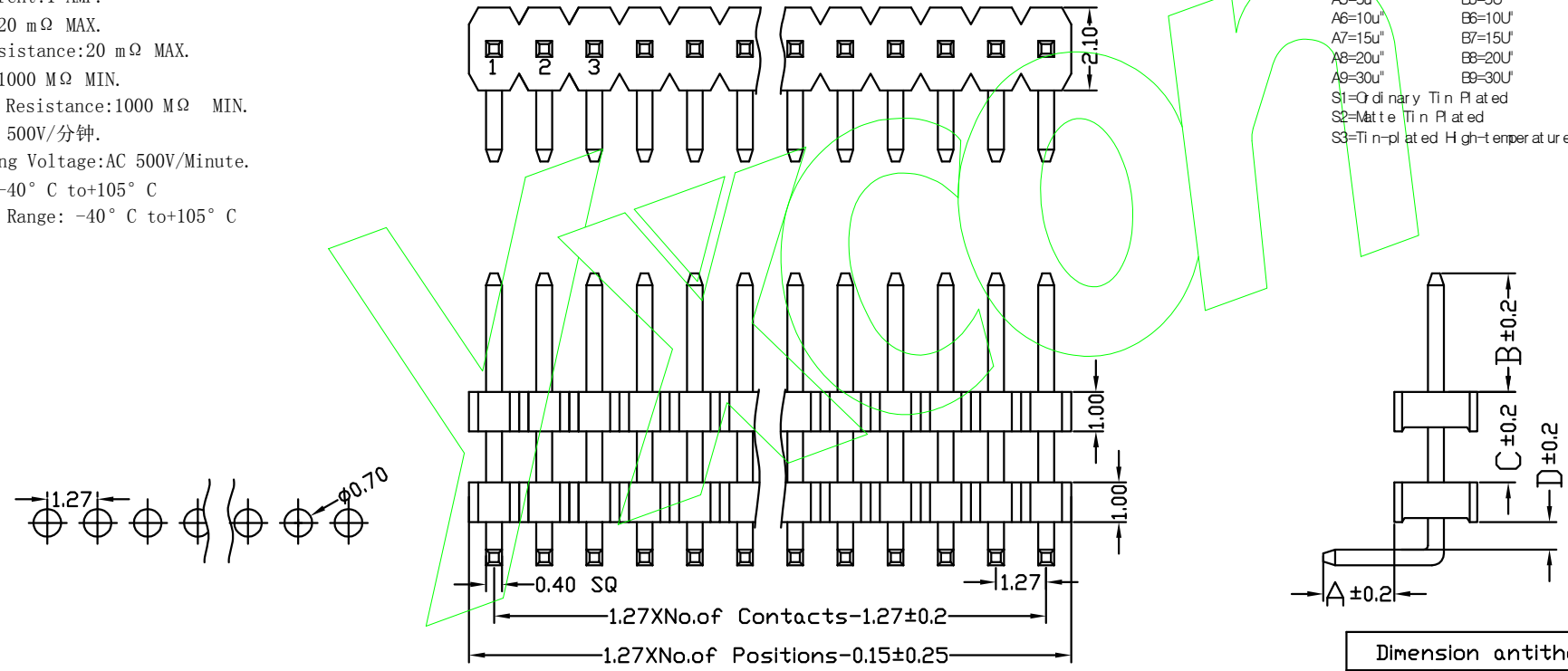

ITEM	A	B	D	C
Standard	1.8	1.8	3.0	4.0
Alternate				

REV	DATE	SYMBOL	MODIFICATION DESCRIPTION	OPERATION		SCALE		Fit		DESIGN	周芳杰 2021.6.15	PART NO	P310-21XXXXXXXXXX1
				X.X	±0.25	UNIT	MM						
				X.XX	±0.20	SIZE	A4	CHECK				TITLE	1.27间距 塑高1.0 单排排针 双塑 90度
				X.XXX	±0.10	SHEET	1/1	APPROVE				Customer No.	
				Angle	±3°	PRQJ.	⊕						
				DIM	TOL								

Yxcon 东莞市宇熙精密连接器有限公司
 Dongguan Yuxi Electronic Co.,Ltd.

Specifications

Ordering Information

P316-11 XX XX X R XXX X X

HEIGHT OF HOUSING	NO. OF PINS PER ROW	Contact Full of Gold	Contact Plating	INSULATOR LENGTH MATERIAL	PACKING TYPE
15: 1.5mm	1-50P	A0=0.8u" A1=1u" A2=1.5u" A3=2u" A4=3u" A5=5u" A6=10u" A7=15u" A8=20u" A9=30u"	B0=0.8U' B1=1U' B2=1.5U' B3=2U' B4=3U' B5=5U' B6=10U' B7=15U' B8=20U' B9=30U'	C: PA6T D: LCP	A: PE Bag B: Tape & Reel C: Tube D: Tube+CAP E: Tray

备注 (Remark)
 1. 材料 (MATERIAL)
 胶芯: PA6T+30%G.F UL94V-0, 颜色: 黑色.
 Housing: PA6T+30%G.F UL94V-0, Color: Black
 四方针: 黄铜, 镍底30u"MIN, 表面镀金0.8u"MIN
 Contact: Brass, 0.8u"MIN GOLD PLATING OVER ALL
 30u" MIN NICKEL UNDERPLATING OVER ALL

2. 特性 (characteristics):
 额定电流: 1 AMP
 Rating Current: 1 AMP.
 接触阻抗: 20 mΩ MAX.
 Contact Resistance: 20 mΩ MAX.
 绝缘阻抗: 1000 MΩ MIN.
 Insulating Resistance: 1000 MΩ MIN.
 耐电压: AC 500V/分钟.
 Withstanding Voltage: AC 500V/Minute.
 温度范围: -40° C to +105° C
 Temperature Range: -40° C to +105° C

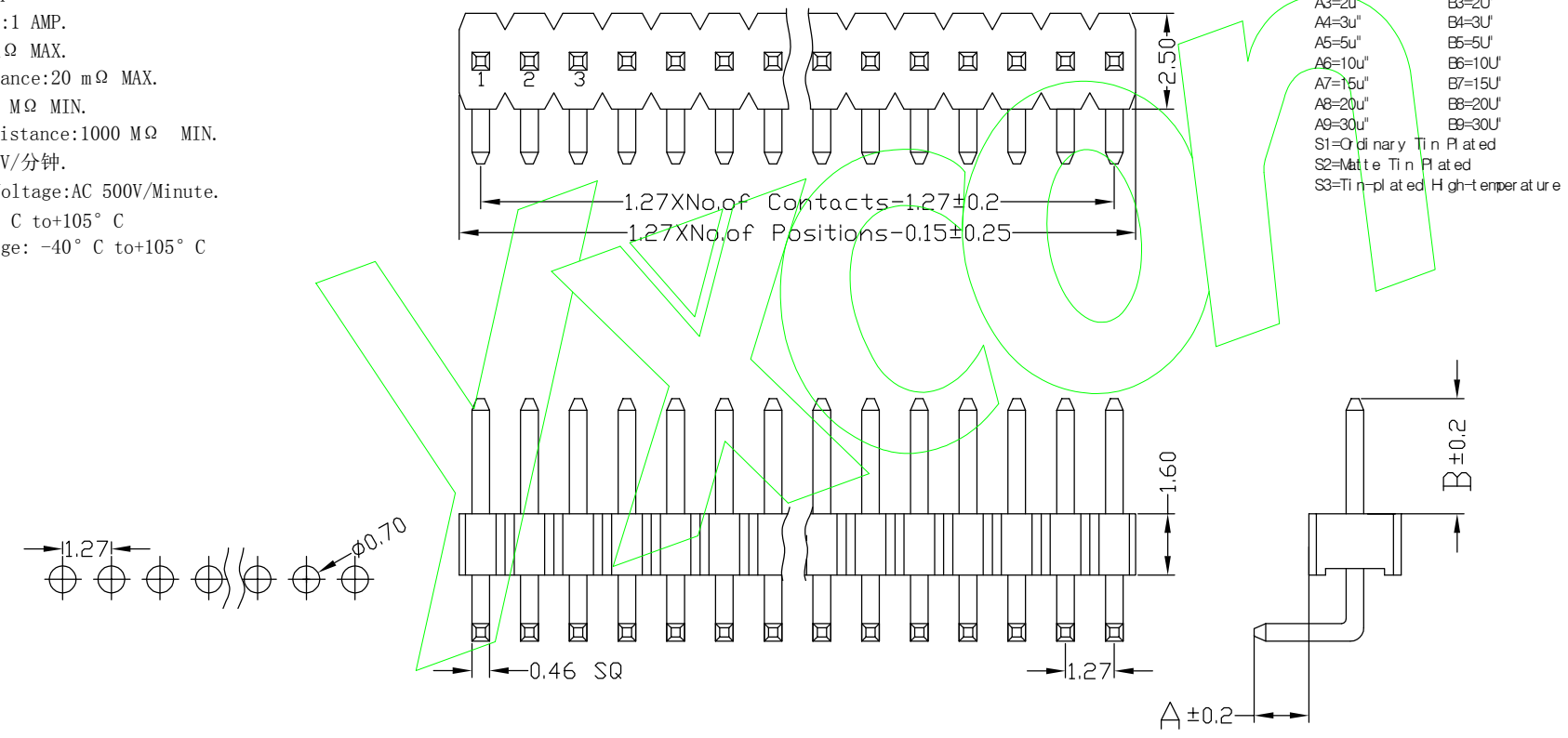

				OPERATION		SCALE		Fit		东莞市宇熙精密连接器有限公司 Dongguan Yuxi Electronic Co., Ltd.			
				X.X	±0.25	UNIT		MM					
				X.XX	±0.20	SIZE	A4	DESIGN	周芳杰 2021.6.15	PART NO.	P316-11XXXXXXRXXXXX		
				X.XXX	±0.10	SHEET	1/1	CHECK		TITLE:	1.27间距 塑高1.6 单排排针 单塑 90度 配0.46针		
REV	DATE	SYMBOL	MODIFICATION DESCRIPTION		Angle	±3°	PROJ.	APPROVE		Customer No.			
					DIM	TOL							

Specifications

备注 (Remark)
 1. 材料 (MATERIAL)
 胶芯: PA6T+30%G.F UL94V-0, 颜色: 黑色.
 Housing: PA6T+30%G.F UL94V-0, Color: Black
 四方针: 黄铜, 镍底30u"MIN, 表面镀金0.8u"MIN
 Contact: Brass, 0.8u"MIN GOLD PLATING OVER ALL
 30u" MIN NICKEL UNDERPLATING OVER ALL

2. 特性 (characteristics):
 额定电流: 1 AMP
 Raring Current: 1 AMP.
 接触阻抗: 20 mΩ MAX.
 Contact Resistance: 20 mΩ MAX.
 绝缘阻抗: 1000 MΩ MIN.
 Insulating Resistance: 1000 MΩ MIN.
 耐电压: AC 500V/分钟.
 Withstanding Voltage: AC 500V/Minute.
 温度范围: -40° C to +105° C
 Temperture Range: -40° C to +105° C

Ordering Information

P325-11 XX XX X R XXX X 1

HEIGHT OF HOUSING	NO. OF PINS PER ROW	Contact Full of Gold	Plating Semi-gold	INSULATOR MATERIAL	LENGTH OF TERMINAL	PACKING
25: 2.5mm	1~50P	A0=0.8u" A1=1u" A2=1.5u" A3=2u" A4=3u" A5=5u" A6=10u" A7=15u" A8=20u" A9=30u"	B0=0.8U" B1=1U" B2=1.5U" B3=2U" B4=3U" B5=5U" B6=10U" B7=15U" B8=20U" B9=30U"	B: PA6T C: PA6T D: LCP	E: TUBE	A: PE Bag B: Tape & Reel C: Tube D: Tube+CAP E: Tray
		S1=Ordinary Tin Plated S2=Matte Tin Plated S3=Tin-plated High-temperature				

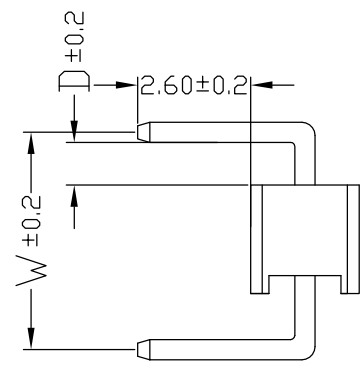
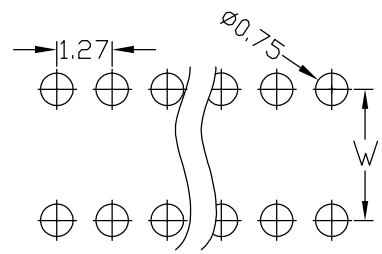
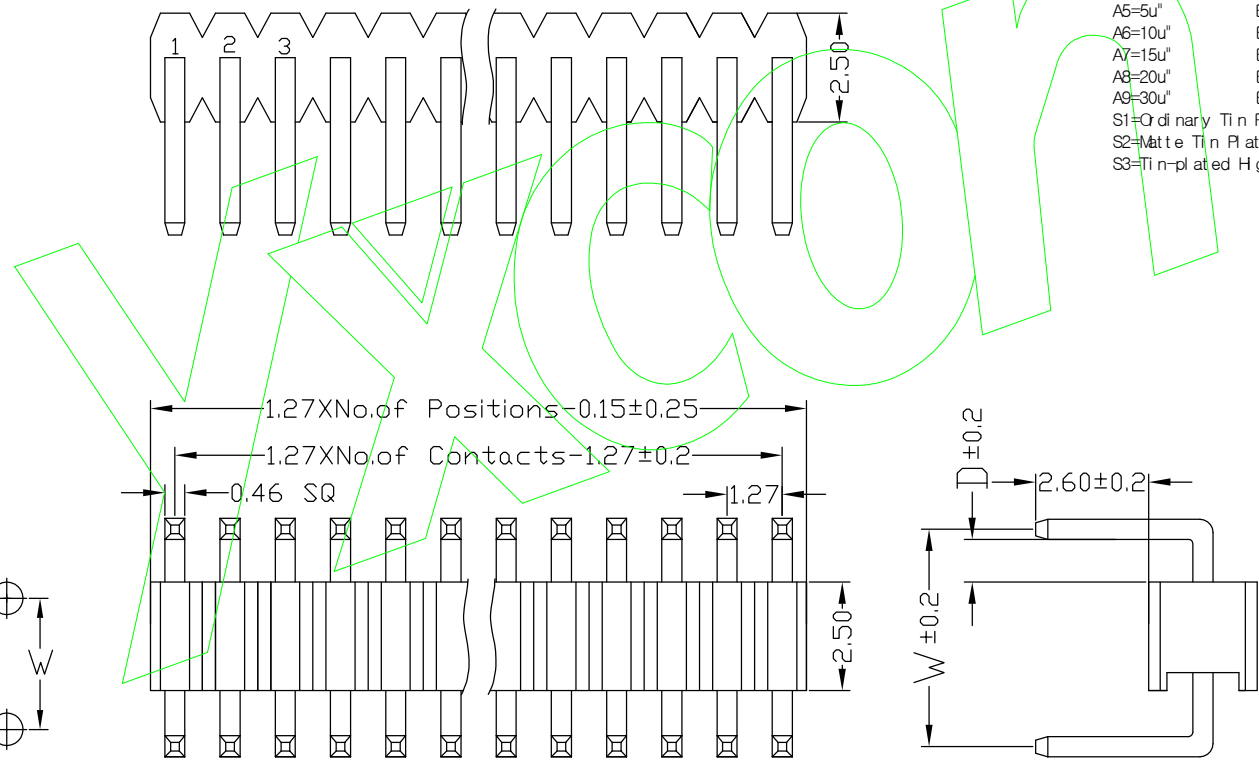

ITEM	W	
Standard	5.0	6.0
Alternate		

				OPERATION		SCALE		Fit		东莞市宇熙精密连接器有限公司 Dongguan Yuxi Electronic Co., Ltd.			
				X.X	±0.40	UNIT		MM					
				X.XX	±0.25	SIZE	A4	DESIGN	周芳杰 2021.6.15	PART NO		P325-11XXXXXXRXXX1	
				X.XXX	±0.15	SHEET	1/1	CHECK		TITLE		1.27间距 塑高2.5 单排排针 单塑 桥型	
REV	DATE	SYMBOL	MODIFICATION DESCRIPTION		Angle	±3°	PROJ.	APPROVE		Customer No.			
					DIM	TOL							