

Specifications

WAFER

備注 (Remark)

1. 材料 (Material)

膠芯: PA66 UL94V-0,

Housing: PA66 UL94V-0

端子: 黃銅

Contact: Brass

9396WV-XX-NOSN-A

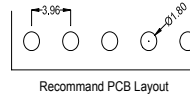
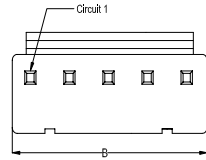

9396WV-XX-NOSN-A

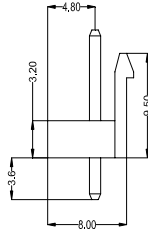
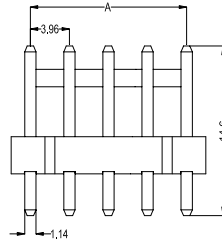

Poles	Dimensions (mm)	
	A	B
2	3.96	7.92
3	7.92	11.88
4	11.88	15.84
5	15.84	19.80
6	19.80	23.76
7	23.76	27.72
8	27.72	31.68
9	31.68	35.64
10	35.64	39.60
11	39.60	43.56
12	43.56	47.52
13	47.52	51.48
14	51.48	55.44
15	55.44	59.40

9396WV-XX-NOSN-A	Nylon 66 UL 94V-0	Brass	Tin-Plated	9396H	1,000Pcs
PART NO	Material	Material(Pin)	Finish(Pin)	Mates With CSWB Housing	Q' ty/Bag

Housing

備注 (Remark)

1. 材料 (Material)

膠芯: PA66 UL94V-0

Housing: PA66 UL94V-0

9396H-XX-N0

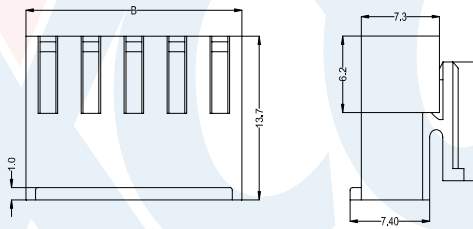
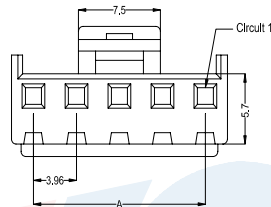

Poles	Dimensions (mm)	
	A	B
2	3.96	8.29
3	7.92	12.25
4	11.88	16.21
5	15.84	20.17
6	19.80	24.13
7	23.76	28.09
8	27.72	32.05
9	31.68	36.01
10	35.64	39.97
11	39.60	43.93
12	43.56	47.89
13	47.52	51.85
14	51.48	55.81
15	55.44	59.77

9396H-XX-N0-C	Nylon 66 UL 94V-0	9396T	9396W	1,000Pcs
9396H-XX-N0	Nylon 66 UL 94V-0			
PART NO	Material	Suitable CSWB Terminal	Mates With CSWB Wafer	Q' ty/Bag



9396H-XX-N0

W

WAFER

Terminal

備注 (Remark)

1. 材料 (Material)

端子: 黃銅

Contact: Brass

9396T-BSN

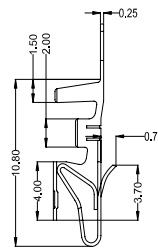
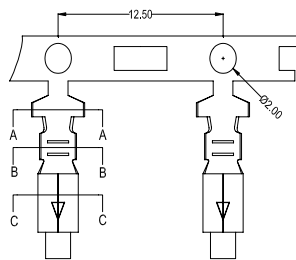

9396T-BSN

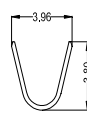

SECTION A-A
SCALE 1:1

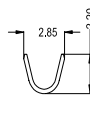

SECTION B-B
SCALE 1:1

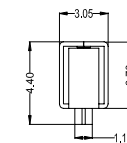

SECTION C-C
SCALE 1:1

9396T-BSN	Brass	AWG#18-22	3.00mm(Max)	Stamping Before Plating:30-50u" Ni;70-120u" Sn	9396H	4,000Pcs
PART NO	Material	Wire Range	Insulation O.D.	Finish	Used In SWB Housing	Q' ty/Reel