

Specifications

Wafer

備注 (Remark)

1. 材料 (Material)

膠芯: PA46/PA66/PA6T UL94V-0

Housing: PA46/PA66/PA6T UL94V-0

端子: 黃銅

Contact: Brass

9821WV-XX-XXSN

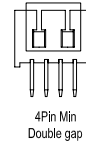
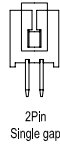
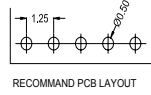
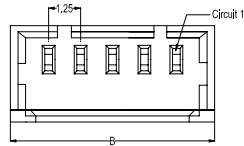

9821WV-XX-XXSN

Poles	Dimensions(mm)	
	A	B
2	1.25	4.25
3	2.50	5.50
4	3.75	6.75
5	5.00	8.00
6	6.25	9.25
7	7.50	10.50
8	8.75	11.75
9	10.00	13.00
10	11.25	14.25
11	12.50	15.50
12	13.75	16.75
13	15.00	18.00
14	16.25	19.25
15	17.50	20.50
16	18.75	21.75

9821WV-XX-6TSN	PA6T UL 94V-0	Brass	Tin-Plated	9821H	1,000Pcs
9821WV-XX-46SN	PA46 UL 94V-0				
9821WV-XX-N0SN	PA66 UL 94V-0				
PART NO	Material	Material(Pin)	Finish(Pin)	Mates With SWB Housing	Qty/Bag

Housing

備注 (Remark)

1. 材料 (Material)

膠芯: PA66/PBT UL94V-0

Housing: PA66/PBT UL94V-0

9821H-XXXX-XXXX

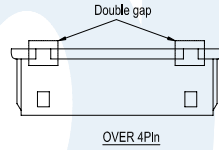
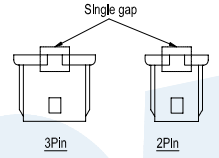
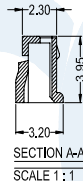
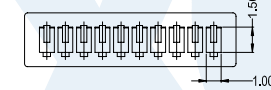
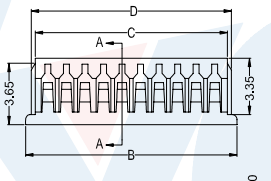
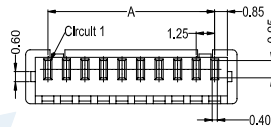

9821H-XXXX-XXXX

Poles	Dimensions (mm)				Poles	Dimensions (mm)			
	A	B	C	D		A	B	C	D
2	1.25	4.25	2.95	3.55	10	11.25	14.25	12.95	13.55
3	2.50	5.50	4.20	4.80	11	12.50	15.50	14.20	14.80
4	3.75	6.75	5.45	6.05	12	13.75	16.75	15.45	16.05
5	5.00	8.00	6.70	7.30	13	15.00	18.00	16.70	17.30
6	6.25	9.25	7.95	8.55	14	16.25	19.25	17.95	18.55
7	7.50	10.50	9.20	9.80	15	17.50	20.50	19.20	19.80
8	8.75	11.75	10.45	11.05	16	18.75	21.75	20.45	21.05
9	10.00	13.00	11.70	12.30					

9821H-XX-PTXX	PBT UL 94V-0	9821T	9821W	1,000Pcs
9821H-XXHF-NOXX	Nylon 66 UL 94V-0 Halogen-Free			
9821H-XX-N0XX	Nylon 66 UL 94V-0			
PART NO	Material	Subtable SWB Terminal	Mates With SWB Wafer	Qty/Bag

Terminal

備注 (Remark)

1. 材料 (Material)

端子: 磷青銅

Contact: Phosphor bronze

9821T-PSN

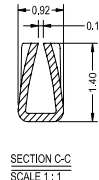
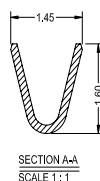
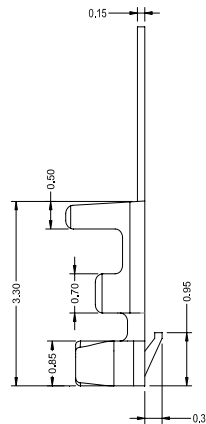
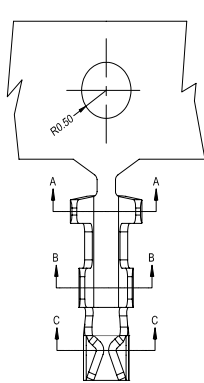

9821T-PSN

9821T-PSN2				Stamping Before Plating: 50u" Min Ni 120u" Sn Min	9821H	15,000Pcs
9821T-PV01	Phosphor Bronze	AWG#28-32	1.00mm(Max)	Stamping Before Plating: 30-50u" Ni/Whole Gold : Gold Flash		
9821T-PSN				Stamping Before Plating: 30-50u" Ni/70-120u" Sn		
PART NO	Material	Wire Range	Insulation O.D.	Finish	Used In SWB Housing	Q' ty/Reel