

### Ordering Information

RP3XX-X XX X X X S 081 1

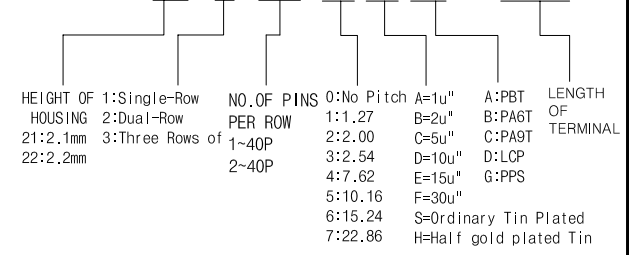

A  
B  
C  
D  
E  
F  
G  
H

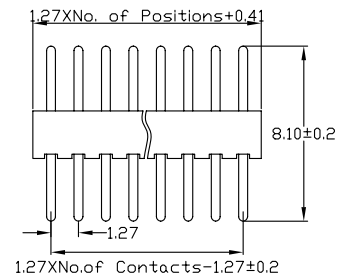
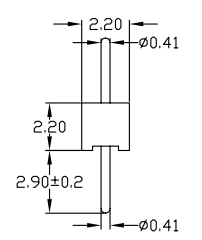

Straight socket connector:solder tail  
single row  
Availability from:2 to 50 contacts  
Standard number of contacts 25 and 50

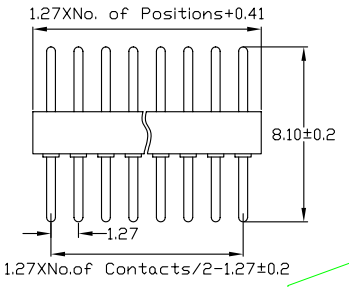
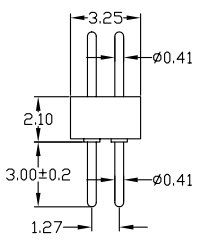

Straight socket connector:solder tail  
double row  
Availability from:4 to 100 contacts  
Standard number of contacts 50 and 100

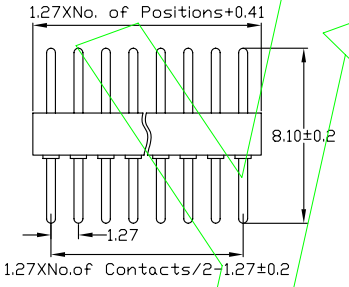
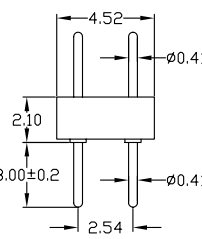

Straight socket connector:solder tail  
double row with 2.54mm row to row distance  
Availability from:4 to 100 contacts  
Standard number of contacts 100

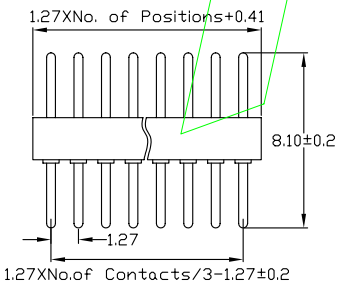
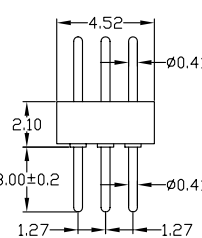

Straight socket connector:solder tail  
triple row  
Availability from:6 to 150 contacts  
Standard number of contacts 150

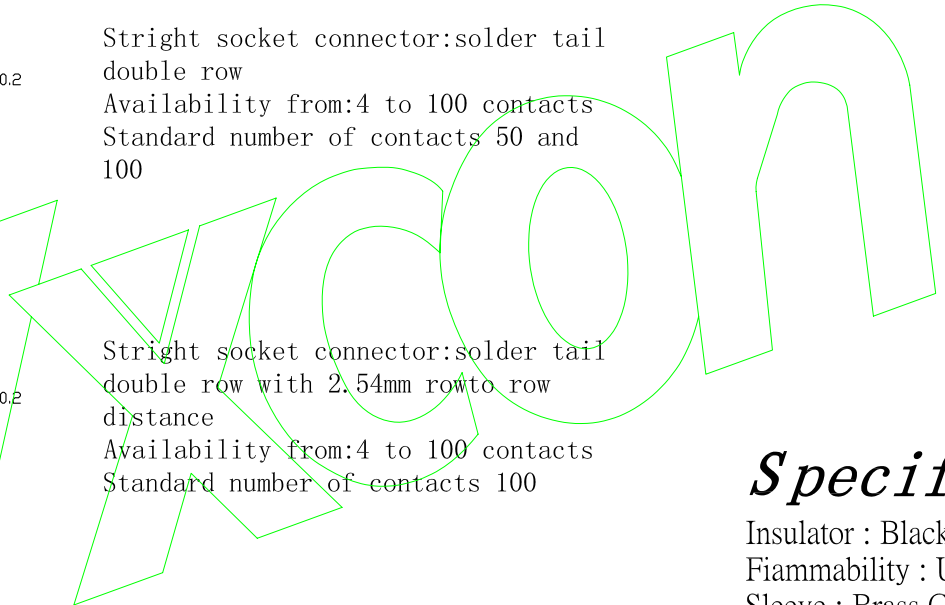

### Specifications

Insulator : Black glass filled polyester PPS-GF30-FR  
 Flammability : UL94V-0  
 Sleeve : Brass CuZn 36Pb3(36000)  
 Mating pin Ø : 0.41 mm  
 Mechancial life : min 500 cycles  
 Rated current : 1Amp  
 Contact resistance: Max 10mΩ  
 Dielectric resistance : Min 1000V<sub>RMS</sub>

				OPERATION		SCALE		Fit		东莞市宇熙精密连接器有限公司 Dongguan Yuxi Electronic Co.,Ltd.	
				X.X	±0.25	UNIT		MM			
				X.XX	±0.20	SIZE	A4	DESIGN	卢小强	PART NO.	RP3XX-XXXXXS0811
				X.XXX	±0.10	SHEET	1/1	CHECK		TITLE:	1.27圆孔排针 180度 L=8.1
REV	DATE	MODIFICATION DESCRIPTION		CHANGE	APPROVE	PROJ.	⊕	APPROVE		Customer No.	