

Specifications

備注 (Remark)

1. 材料 (Material)

膠芯: PA9T/LCP+30%G. F UL94V-0, 顏色: 黑色

Housing: PA9T/LCP+30%G. F UL94V-0, Color: Black

端子: 黃銅

Contact: Brass

2. 特性 (characteristics):

額定電流: 7.0AMP

Rating Current: 7.0AMP

接觸阻抗: 20mΩ Max

Contact Resistance: 20mΩ Max

絕緣阻抗: 1000MΩ Min

Insulating Resistance: 1000 MΩ Min

耐電壓: AC 500V/分鐘

Withstanding Voltage: AC 500V/Minute

溫度範圍: -40° C to +105° C

Temperature Range: -40° C to +105° C

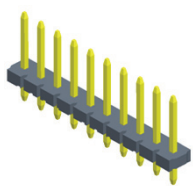

P825-11XXXXXSXXX1

L=A+B+2.5



P825-11XXXXRXXXX1

L=A+B+D+5.65

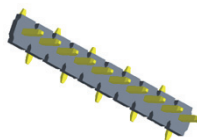

P825-11XXXXMXXX1

L=B+D+2.5+W/2

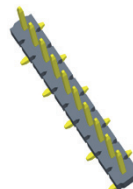

P825-11XXXXMXXX2

L=B+D+2.5+W/2

Mating With/配對母座:
F889

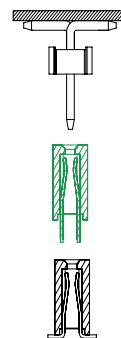

Dimension antitheses list		
ITEM	A	B
Standard	3.50	8.00
Alternate		

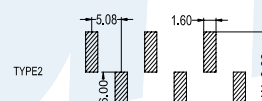
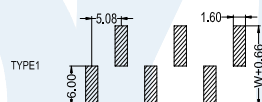
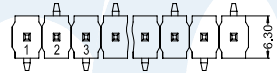
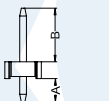
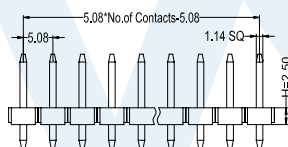
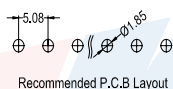
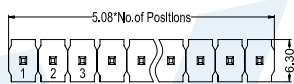

Recommended P.C.B Layout

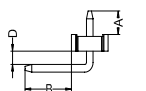
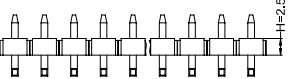
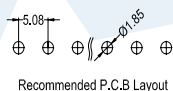
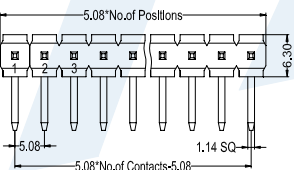

Dimension antitheses list			
ITEM	A	B	D
Standard	3.50	8.00	2.00
Alternate			

Dimension antitheses list			
ITEM	B	D	W
Standard	8.00	0.45	10.0
Alternate			

PIN HEADER

P 8 2 5 - 1 1

X X

X X

X

X

X X X

X

X

No.Of Pins Per Row
02~20P

Contact Plating
Full Of Gold A0=0.8u"
Semi-Gold B0=0.8u"
A9=30u" B9=30u"
S1=Ordinary Tin Plated
S2=Matte Tin Plated
S3=Tin-plated High-temperature

Insulator Material:
B:PA6T
C:PA9T
D:LCP

Contact Shape:
S: Straight
R: Right Angle
M: SMT

Length Of Terminal
Packing
A: PE Bag
B: Tape & Reel
C: Tube
D: Tube+CAP
E: Tray

Journal Number
1: Type1
2: Type2

[Http://www.yxcon.com](http://www.yxcon.com)

E-mail: yx@yxcon.com

YUXI DONGGUAN (東莞)
YUXI TAIWAN (台灣)

TEL:+86 769 85397456
TEL:+886 3313 2933

FAX:+86 769 85396015
FAX:+886 3313 2935

Specifications

備注 (Remark)

1. 材料 (Material)

膠芯: PA9T/LCP+30%G. F UL94V-0, 顏色: 黑色

Housing: PA9T/LCP+30%G. F UL94V-0, Color: Black

端子: 黃銅

Contact: Brass

2. 特性 (characteristics):

額定電流: 7.0AMP

Rating Current: 7.0AMP

接觸阻抗: 20mΩ Max

Contact Resistance: 20mΩ Max

絕緣阻抗: 1000MΩ Min

Insulating Resistance: 1000 MΩ Min

耐電壓: AC 500V/分鐘

Withstanding Voltage: AC 500V/Minute

溫度範圍: -40° C to +105° C

Temperture Range: -40° C to +105° C

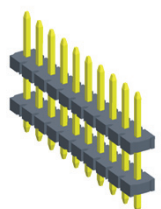

P825-21XXXXXSXXX1
L=A+B+C

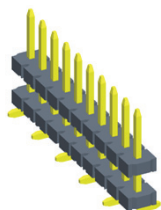

P825-21XXXXMXXX1
L=B+C+D+W2

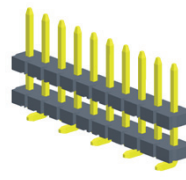

P825-21XXXXMXXX2
L=B+C+D+W2

Mating With/配對母座:
F889

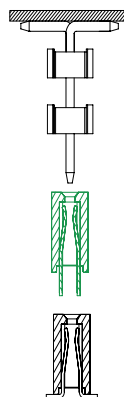

PIN HEADER

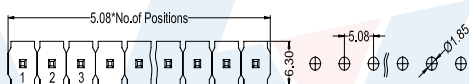

Recommended P.C.B Layout

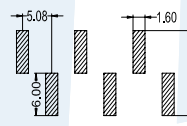
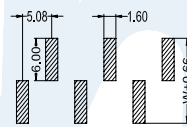
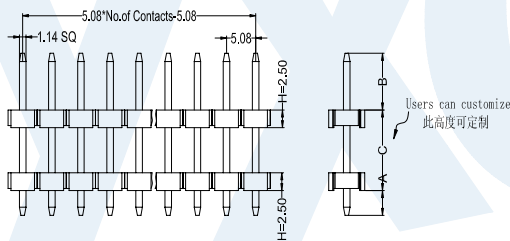

Recommended P.C.B Layout

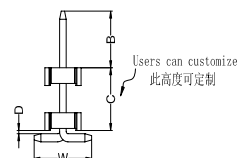
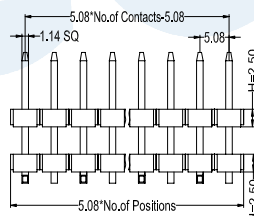

Dimension anitheses list			
ITEM	A	B	C
Standard	3.50	8.00	
Alternate			

Dimension anitheses list				
ITEM	B	C	D	W
Standard	8.00	0.45	10.0	
Alternate				

P 8 2 5 - 2 1

XX

XX

X

X

XXX

X

X

No.Of Pins Per Row
02~20P

Contact Plating
Full Of Gold
A0=0.8u"
Semi-Gold
B0=0.8U"
~
A9=30u" B9=30U"
S1=Ordinary Tin Plated
S2=Matte Tin Plated
S3=Tin-plated High-temperature

Insulator Material:
B:PA6T
C:PA9T
D:LCP

Contact Shape:
S: Straight
M: SMT

Length Of Terminal

Packing
A: PE Bag
B: Tape & Reel
C: Tube
D: Tube+CAP
E: Tray

Journal Number
1: Type1
2: Type2

Http://www.yxcon.com

E-mail: yx@yxcon.com

YUXI DONGGUAN (東莞)
YUXI TAIWAN (台灣)

TEL: +86 769 85397456
TEL: +886 3313 2933

FAX: +86 769 85396015
FAX: +886 3313 2935

Specifications

備注 (Remark)

1. 材料 (Material)

膠芯: PA9T/LCP+30%G. F UL94V-0, 顏色: 黑色

Housing: PA9T/LCP+30%G. F UL94V-0, Color: Black

端子: 黃銅

Contact: Brass

2. 特性 (characteristics):

額定電流: 7.0AMP

Rating Current: 7.0AMP

接觸阻抗: 20mΩ Max

Contact Resistance: 20mΩ Max

絕緣阻抗: 1000MΩ Min

Insulating Resistance: 1000 MΩ Min

耐電壓: AC 500V/分钟

Withstanding Voltage: AC 500V/Minute

溫度範圍: -40° C to +105° C

Temperature Range: -40° C to +105° C

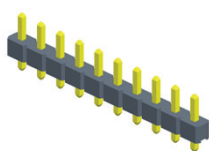

P830-11XXXXXSXXX1

L=A+B+3.0

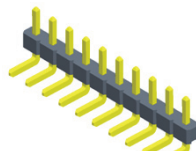

P830-11XXXXRXRXXX1

L=A+B+D+5.65

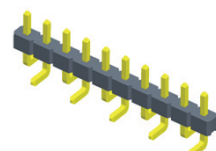

P830-11XXXXXMXXX1

L=B+D+3.0+W/2

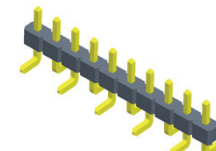

P830-11XXXXMXXX2

L=B+D+3.0+W/2

Mating With/配對母座:
F889

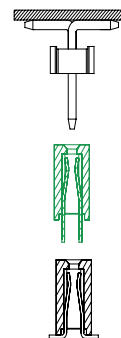

Dimension antitheses list

ITEM	A	B
Standard	3.50	8.00
Alternate		

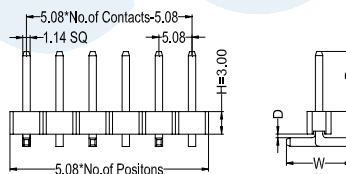
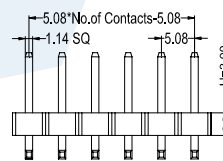
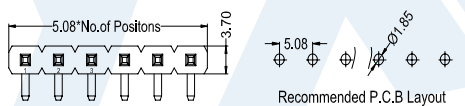
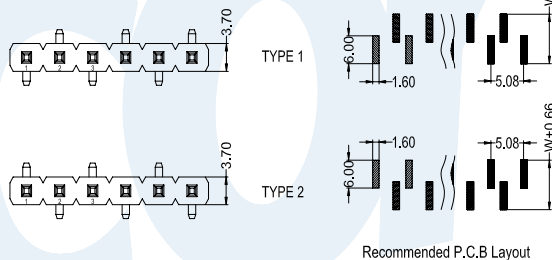
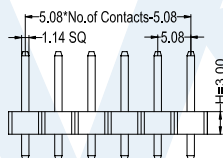
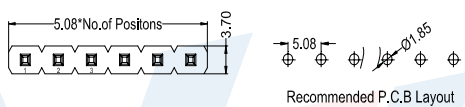

Dimension antitheses list

ITEM	A	B	D
Standard	3.50	8.00	2.00
Alternate			

Dimension antitheses list

ITEM	B	D	W
Standard	8.00	0.45	10.0
Alternate			

P 8 3 0 - 1 1

XX

XX

X

X

XXX

X

X

No.Of Pins Per Row
02~20P

Contact Plating
Full Of Gold A0=0.8u"
Semi-Gold B0=0.8U"
~
A9=30u" B9=30U"
S1=Ordinary Tin Plated
S2=Matte Tin Plated
S3=Tin-plated High-temperature

Insulator Material:
B:PA6T
C:PA9T
D:LCP

Contact Shape:
S: Straight
R: Right Angle
M: SMT

Length Of Terminal

Packing
A: PE Bag
B: Tape & Reel
C: Tube
D: Tube+CAP
E: Tray

Journal Number
1: Type1
2: Type2

[Http://www.yxcon.com](http://www.yxcon.com)

E-mail: yx@yxcon.com

YUXI DONGGUAN (東莞)
YUXI TAIWAN (台灣)

TEL:+86 769 85397456
TEL:+886 3313 2933

FAX:+86 769 85396015
FAX:+886 3313 2935

Specifications

備注 (Remark)

1. 材料 (Material)

膠芯: PA9T/LCP+30%G. F UL94V-0, 顏色: 黑色

Housing: PA9T/LCP+30%G. F UL94V-0, Color: Black

端子: 黃銅

Contact: Brass

2. 特性 (characteristics):

額定電流: 7.0AMP

Rating Current: 7.0AMP

接觸阻抗: 20mΩ Max

Contact Resistance: 20mΩ Max

絕緣阻抗: 1000MΩ Min

Insulating Resistance: 1000 MΩ Min

耐電壓: AC 500V/分钟

Withstanding Voltage: AC 500V/Minute

溫度範圍: -40° C to +105° C

Temperture Range: -40° C to +105° C

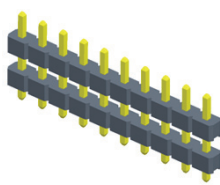

P830-21XXXXXSXXXX1
L=A+B+C

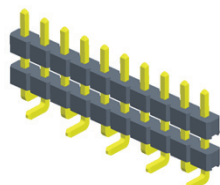

P830-21XXXXMXXXXX1
L=B+C+D+W2

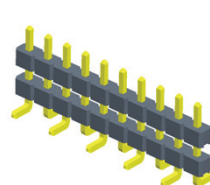

P830-21XXXXMXXXXX2
L=B+C+D+W2

Mating With/配對母座:
F889

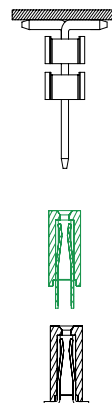

PIN HEADER

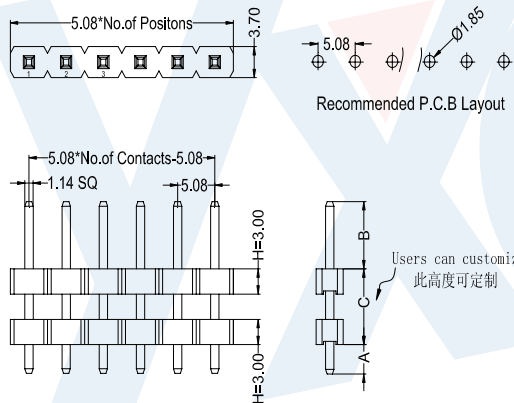

Dimension anitheses list			
ITEM	A	B	C
Standard	3.50	8.00	
Alternate			

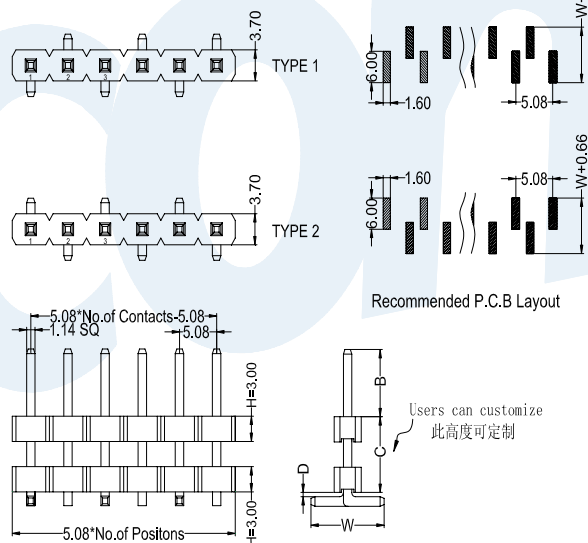

Dimension anitheses list				
ITEM	B	D	C	W
Standard	8.00	0.45		10.0
Alternate				

P 8 3 0 - 2 1

XX

XX

X

X

XXX

X

X

No.Of Pins Per Row
02~20P

Contact Plating
Full Of Gold
A0=0.8u"
Semi-Gold
B0=0.8u"

A9=30u"
S1=Ordinary Tin Plated
S2=Matte Tin Plated
S3=Tin-plated High-temperature

Insulator Material:
B:PA6T
C:PA9T
D:LCP

Contact Shape:
S: Straight
M: SMT

Length Of Terminal

Packing
A: PE Bag
B: Tape & Reel
C: Tube
D: Tube+CAP
E: Tray

Journal Number
1: Type1
2: Type2

[Http://www.yxcon.com](http://www.yxcon.com)

[E-mail:yx@yxcon.com](mailto:yx@yxcon.com)

YUXI DONGGUAN (東莞)
YUXI TAIWAN (台灣)

TEL:+86 769 85397456
TEL:+886 3313 2933

FAX:+86 769 85396015
FAX:+886 3313 2935

Specifications

備注 (Remark)

1. 材料 (Material)

膠芯: PA9T/LCP+30%G.F UL94V-0, 顏色: 黑色

Housing: PA9T/LCP+30%G.F UL94V-0, Color: Black

端子: 黃銅

Contact: Brass

2. 特性 (characteristics):

額定電流: 7.0AMP

Rating Current: 7.0AMP

接觸阻抗: 20mΩ Max

Contact Resistance: 20mΩ Max

絕緣阻抗: 1000MΩ Min

Insulating Resistance: 1000 MΩ Min

耐電壓: AC 500V/分鐘

Withstanding Voltage: AC 500V/Minute

溫度範圍: -40° C to +105° C

Temperature Range: -40° C to +105° C

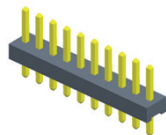

P832-11XXXXXSXXXX1

$L=A+B+3.2$

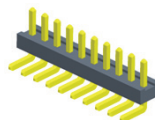

P832-11XXXXRXXXXX1

$L=A+B+D+5.65$

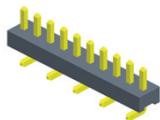

P832-11XXXXMXXXX1

$L=B+D+3.2+W/2$

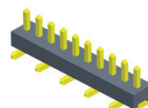

P832-11XXXXMXXXX2

$L=B+D+3.2+W/2$

Mating With/配對母座:
F889

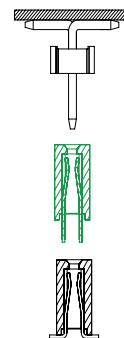

Dimension anitheses list		
ITEM	A	B
Standard	3.50	8.00
Alternate		

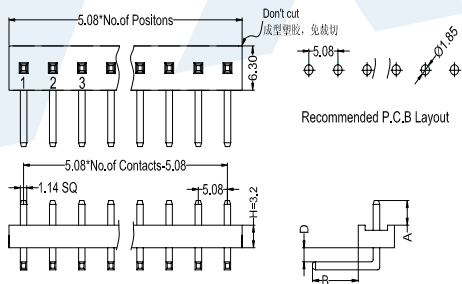
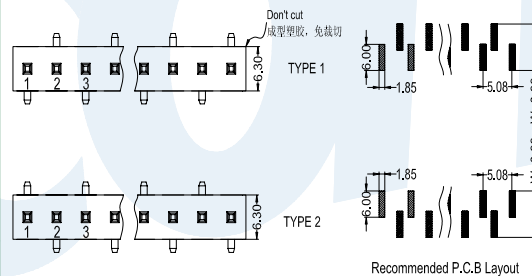
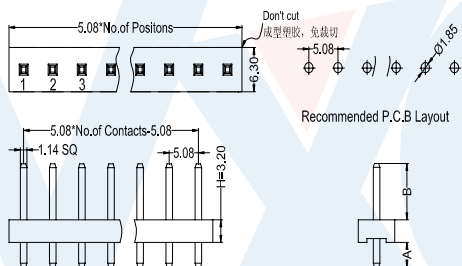

Dimension anitheses list			
ITEM	A	B	D
Standard	3.5	8.00	2.00
Alternate			

Dimension anitheses list			
ITEM	B	D	W
Standard	8.00	0.45	10.0
Alternate			

P 8 3 2 - 1 1

X X

X X

X

X

X X X

X

X

No.Of Pins Per Row
02~20P

Contact Plating
Full Of Gold A0=0.8u"
Semi-Gold B0=0.8U"
A9=30u" B9=30U"
S1=Ordinary Tin Plated
S2=Matte Tin Plated
S3=Tin-plated High-temperature

Insulator Material:
B:PA6T
C:PA9T
D:LCP

Contact Shape:
S: Straight
R: Right Angle
M: SMT

Length Of Terminal

Packing
A: PE Bag
B: Tape & Reel
C: Tube
D: Tube+CAP
E: Tray

Journal Number
1: Type1
2: Type2

