

Specifications

备注 (Remark)

1. 材料 (MATERIAL)

胶芯: PA6T+30%G.F UL94V-0, 颜色: 黑色.

Housing: PA6T+30%G.F UL94V-0, Color: Black

四方针: 黄铜, 镀底30u"MIN, 表面镀金0.8u"MIN

Contact: Brass, 0.8u"MIN GOLD PLATING OVER ALL
30u" MIN NICKEL UNDERPLATING OVER ALL

2. 特性 (characteristics):

额定电流: 0.75 AMP

Rating Current: 0.75 AMP.

接触阻抗: 20 mΩ MAX.

Contact Resistance: 20 mΩ MAX.

绝缘阻抗: 1000 MΩ MIN.

Insulating Resistance: 1000 MΩ MIN.

耐电压: AC 500V.

Withstanding Voltage: AC 500V.

温度范围: -40°C to+105°C

Temperature Range: -40°C to+105°C

Ordering Information

P5XX-11 XX XX X M XXX X X

HEIGHT OF HOUSING 10:1.0mm 15:1.5mm	NO.OF PINS PER ROW 1~50P	Contact Plating		INSULATOR MATERIAL: OF	LENGTH OF TERMINAL	PACKING A:PE Bag B:Tape & Reel C:Tube D:Tube+CAP E:Tray	TYPE1:1 TYPE2:2
		Full Of Gold	Semi-gold				
		A0=0.8u" A1=1u" A2=1.5u" A3=2u" A4=3u" A5=5u" A6=10u" A7=15u" A8=20u" A9=30u"	B0=0.8u" B1=1u" B2=1.5u" B3=2u" B4=3u" B5=5u" B6=10u" B7=15u" B8=20u" B9=30u"	B:PA6T C:PA9T D:LCP			
		S1=Ordinary Tin Plated S2=Matte Tin Plated S3=Tin-plated High-temperature					

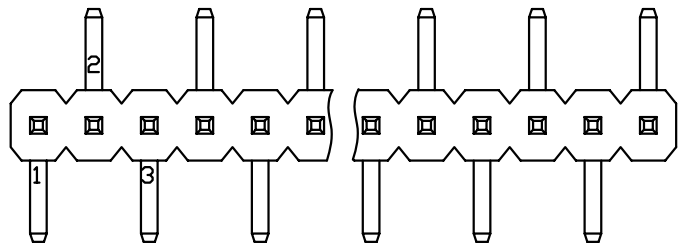

TYPE 1

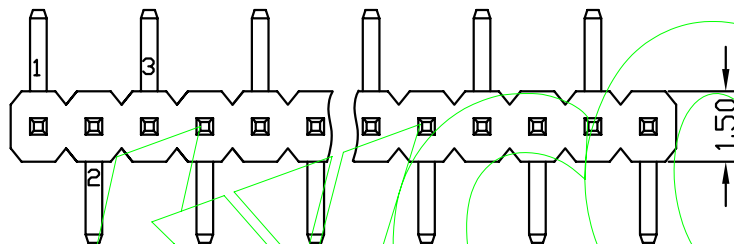

TYPE 2

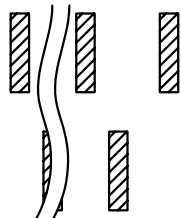

TYPE 1

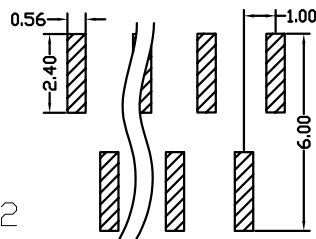

TYPE 2

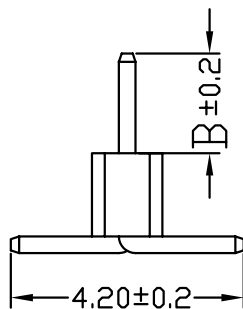
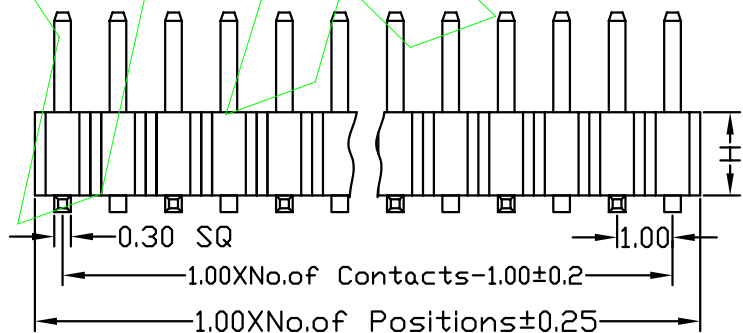

Dimension antitheses list

ITEM	B	D	H	
Standard	1.8	0	1.0	1.5
Alternate				

				OPERATION		SCALE		Fit		东莞市宇熙精密连接器有限公司 Dongguan Yuxi Electronic Co.,Ltd.			
				X.X	±0.25	UNIT		MM					
				X.XX	±0.20	SIZE	A4	DESIGN	卢小强	PART NO.		P5XX-11XXXXXX	
				X.XXX	±0.10	SHEET	1/1	CHECK		TITLE:		1.00mm 排针 单排 SMT	
REV	DATE	MODIFICATION DESCRIPTION		CHANGE	APPROVE	DIM	TOL	PROJ.	APPROVE	Customer No.			