

Specifications

Wafer

備注 (Remark)

1. 材料 (Material)

膠芯: PA66 UL94V-0

Housing: PA66 UL94V-0

端子: 黃銅

Contact: Brass

1502WV-XXK1-NOSN

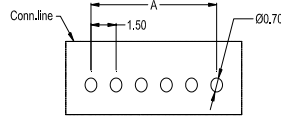
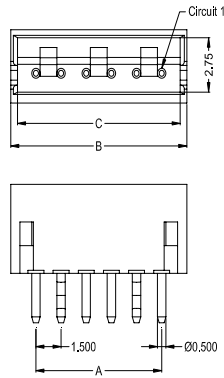

Recommended P.C.B Layout

Poles	Dimensions(mm)			Poles	Dimensions(mm)		
	A	B	C		A	B	C
02	1.50	4.50	3.70	08	10.50	13.50	12.70
03	3.00	6.00	5.20	09	12.00	15.00	14.20
04	4.50	7.50	6.70	10	13.50	16.50	15.70
05	6.00	9.00	8.20	11	15.00	18.00	17.20
06	7.50	10.50	9.70	12	16.50	19.50	18.70
07	9.00	12.00	11.20				

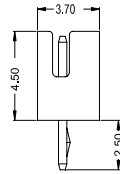

1502WV-XXK1-NOSN	Nylon 66 UL 94V-0	Brass	Tin-Plated	1502H
PART NO	Material	Material(Pin)	Finish(Pin)	Mates With SWB Housing



1502WV-XXK1-NOSN

Housing

備注 (Remark)

1. 材料 (Material)

膠芯: PA66 UL94V-0

Housing: PA66 UL94V-0

1502H-XX-N0

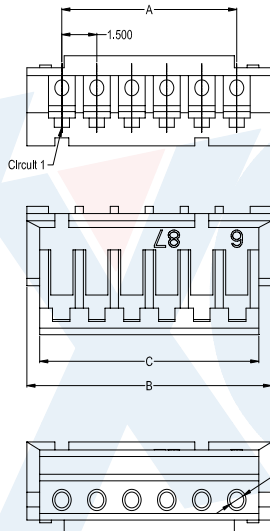

Poles	Dimensions(mm)			Poles	Dimensions(mm)		
	A	B	C		A	B	C
02	1.50	4.50	1.40	09	12.00	15.00	11.90
03	3.00	6.00	2.90	10	13.50	16.50	13.40
04	4.50	7.50	4.40	11	15.00	18.00	14.90
05	6.00	9.00	5.90	12	16.50	19.50	16.40
06	7.50	10.50	7.40	13	18.00	21.00	17.90
07	9.00	12.00	8.90	14	19.50	22.50	19.40
08	10.50	13.50	10.40	15	21.00	24.00	20.90

1502H-XX-N0	PA66 UL 94V-0	1502T	1502W
PART NO	Material	Suitable SWB Terminal	Mates With SWB Wafer



1502H-XX-N0

Terminal

備注 (Remark)

1. 材料 (Material)

端子: 磷青銅

Contact: Phosphor bronze

1502T-PSN

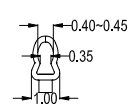
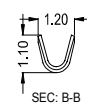
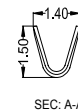
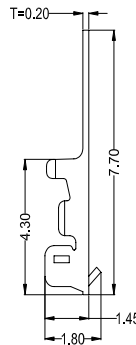
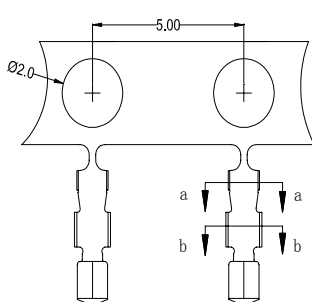

1502T-PSN

1502T-PSN	Phosphor Bronze	AWG#28-32	1.10mm(Max)	Stamping Before Plating: 30~50u" Ni; 70~120u" Sn	1502H	10,000Pcs
PART NO	Material	Wire Range	Insulation O.D.	Finish	Used In CSWB Housing	Q' ty/Reel