

Specifications

备注 (Remark)

1. 材料 (MATERIAL)

胶芯: LCP+30%G.F UL94V-0, 颜色: 黑色.

Housing: LCP+30%G.F UL94V-0, Color: Black

四方针: 黄铜, 镍底30u"MIN, 镀普通锡

Contact: Brass, ORDINARY TIN PLATED

30u" MIN NICKEL UNDERPLATING OVER ALL

2. 特性 (characteristics):

额定电流: 7 AMP

Rating Current: 7 AMP.

接触阻抗: 20 mΩ MAX.

Contact Resistance: 20 mΩ MAX.

绝缘阻抗: 1000 MΩ MIN.

Insulating Resistance: 1000 MΩ MIN.

耐电压: AC 500V.

Withstanding Voltage: AC 500V.

温度范围: -40°C to+105°C

Temperature Range: -40°C to+105°C

Ordering Information

P825-21 XX XX D S XXX X 1

HEIGHT OF HOUSING 25:2.5mm	NO. OF PINS PER ROW 1-20P	Contact Plating Full Of Gold A0=0.8u" A1=1u" A2=1.5u" A3=2u" A4=3u" A5=5u" A6=10u" A7=15u" A8=20u" A9=30u"	Semi-gold B0=0.8u" B1=1u" B2=1.5u" B3=2u" B4=3u" B5=5u" B6=10u" B7=15u" B8=20u" B9=30u"	INSULATOR MATERIAL: D:LCP	LENGTH OF TERMINAL	PACKING A:PE Bag B:Tape & Reel C:Tube D:Tube+CAP E:Tray
		S1=Ordinary Tin Plated S2=Matte Tin Plated S3=Tin-plated High-temperature				

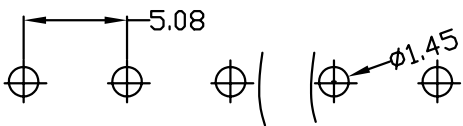
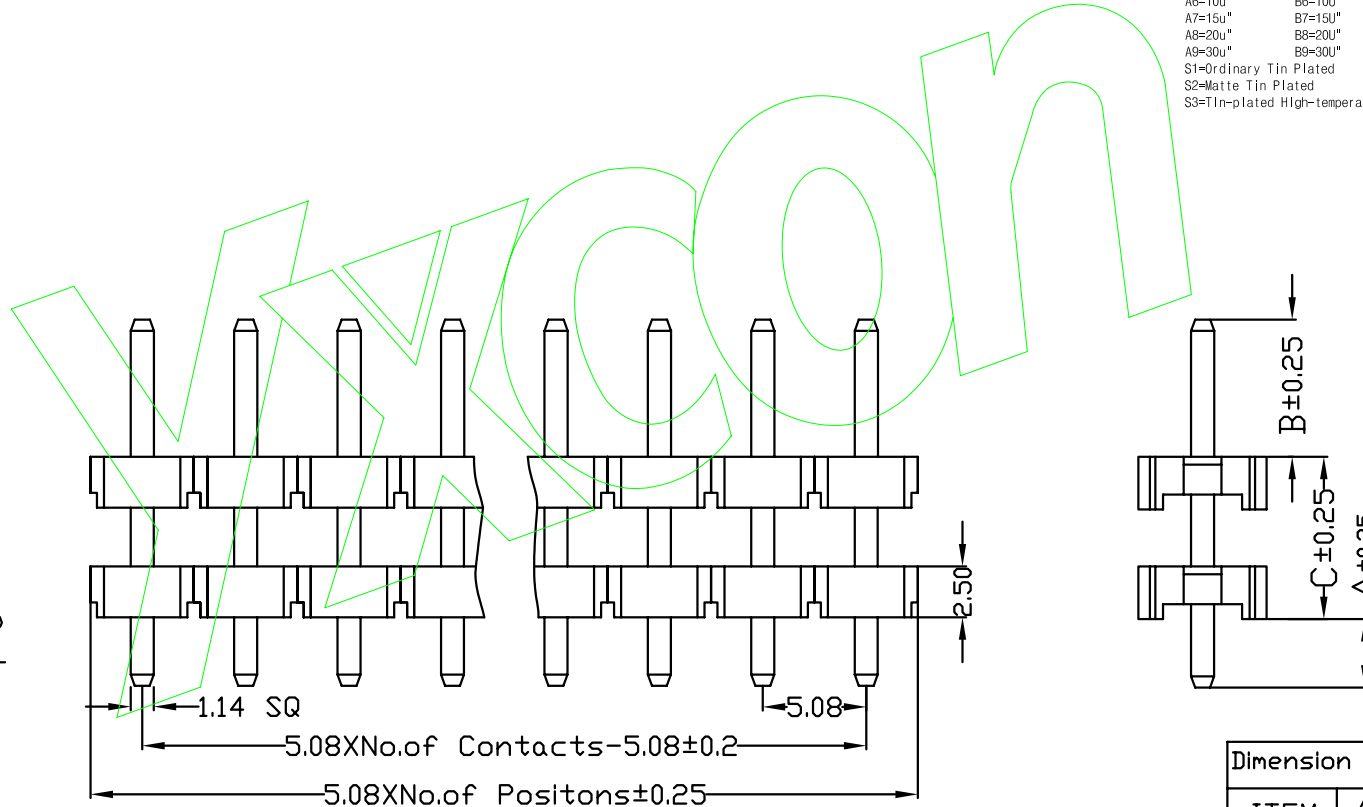
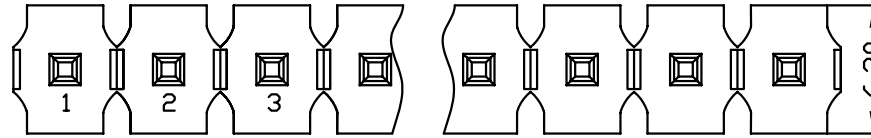

ITEM	A	B	C
Standard	2.54	4.5	15
Alternate			

				OPERATION		SCALE	Fit	东莞市宇熙精密连接器有限公司 Dongguan Yuxi Electronic Co.,Ltd.			
				X.X	±0.25	UNIT	MM				
				X.XX	±0.20	SIZE	A4	DESIGN	卢小强	PART NO.	P825-21XXXXXSXXXX1
				X.XXX	±0.10	SHEET	1/1	CHECK		TITLE:	5.08mm 单排针 双塑 塑高2.5 180度
REV	DATE	MODIFICATION DESCRIPTION	CHANGE	APPROVE	Angle	±3°	PROJ.	APPROVE		Customer No.	